

RJ500



An excellent structural stability is ensured by inertial mass comprising concrete blocks.

RJ 500

Mobile anchor rail

EN 795:2012 CLASS D
CEN/TS 16415:2013

Ref. no.: RJ 500

Mobile anchor rail RJ 500 is a complete fall protection system. An excellent structural stability is ensured by inertial mass comprising concrete blocks so it is not necessary to provide stable foundation or a support structure. RJ 500 is a modular device which can be interconnected to create any number of configurations and lengths as needed. Standard length of the rail is 6 running metres providing a track for horizontal travel of trolleys being anchor points for protected users. The rail is placed at 6.88m. RJ 500 is a device that will suit perfectly i.e. when servicing tanks, on railway siding and repair stations and whenever it is necessary to move safely on horizontal surfaces at a height.

TECHNICAL DATA

Material:	galvanized steel
Weight of concrete unit weights - 4 pcs.:	4100 kg
Weight of structure:	1420 kg
Length of rail of single segment:	6 m
Maximum number of users:	3

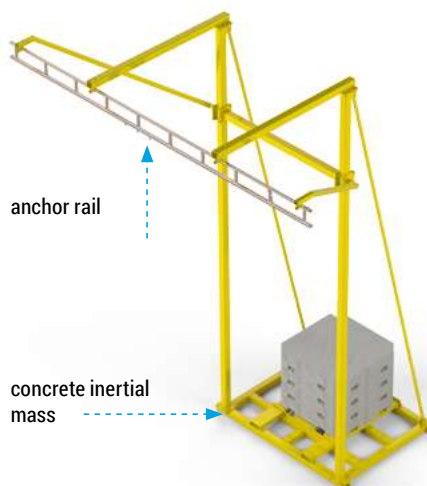
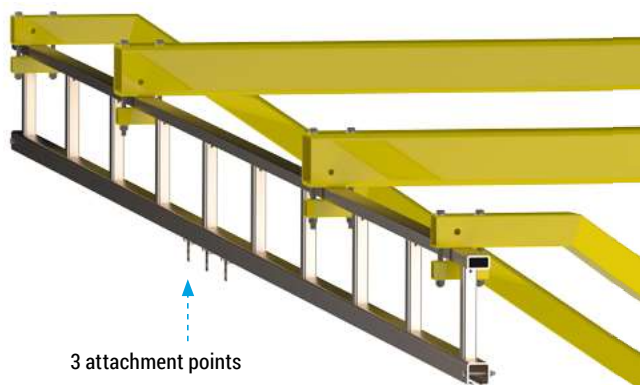

EXAMPLE MODULAR CONNECTION

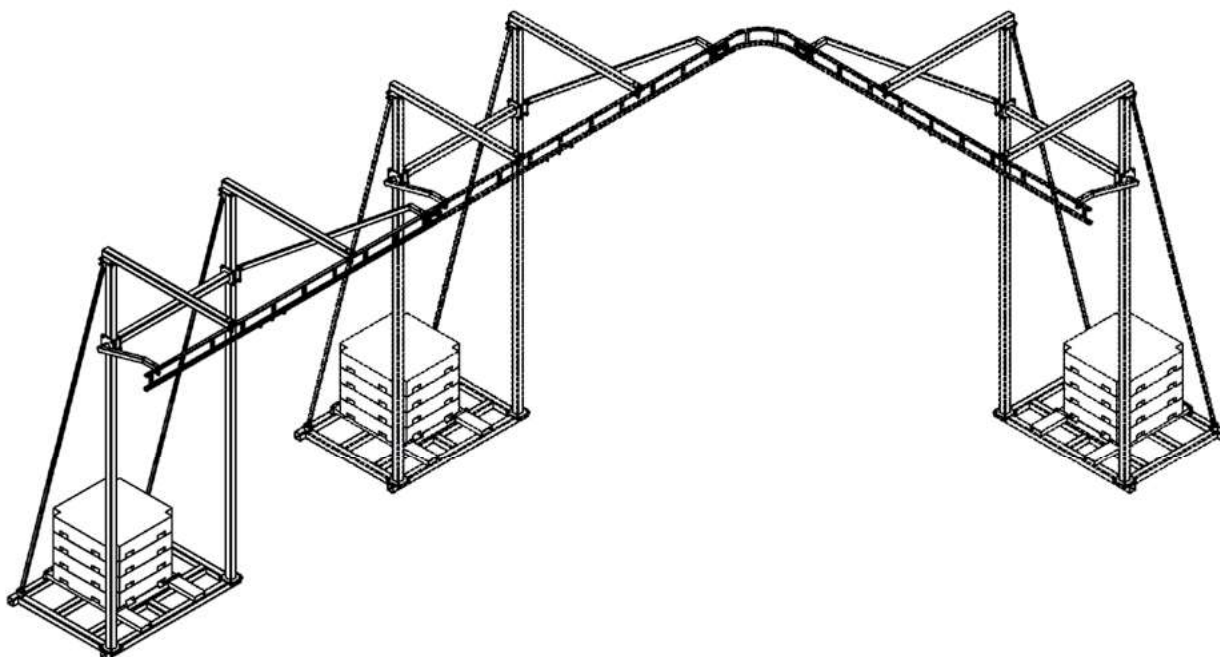

Dimensions

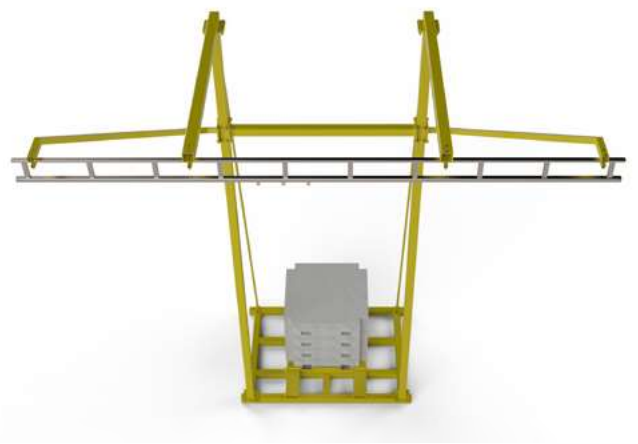
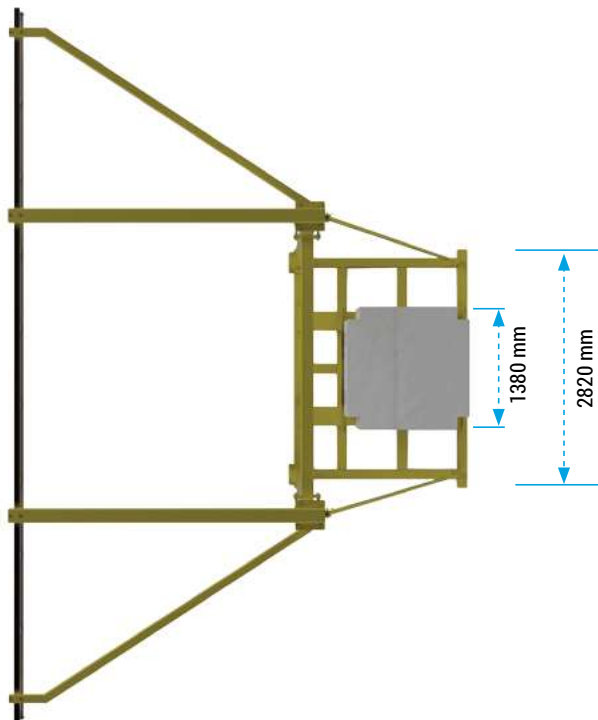
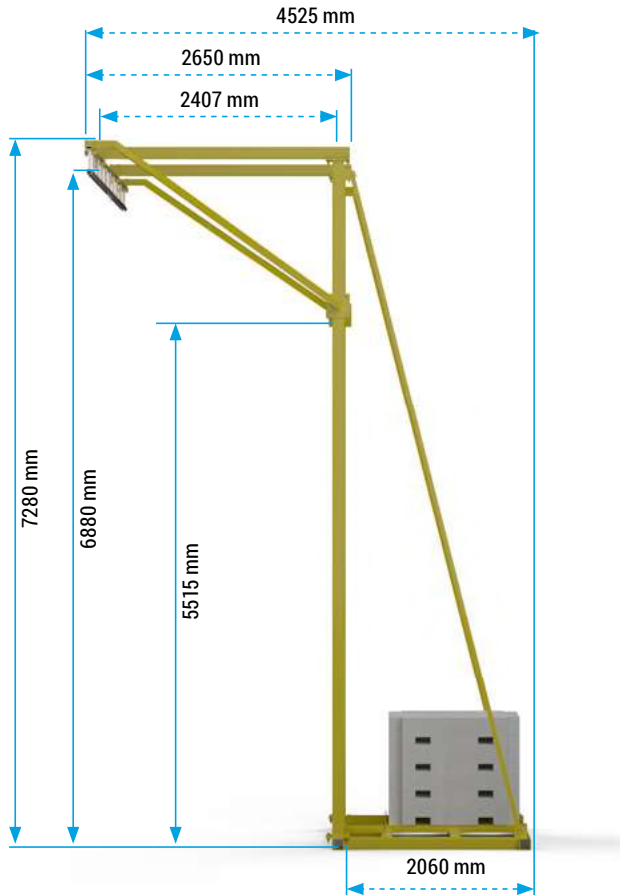



Elements of RJ500 kit

1. FRAME + 4 CONCRETE UNIT WEIGHTS
RJ500 KIT



2. CONCRETE UNIT WEIGHT
1000 KG +/- 20 KG
RJ200.10.000



3. RETRACTABLE TYPE FALL ARRESTER
CR 250V 10



**4. GUARD FOR RETRACTABLE
TYPE FALL ARRESTER
OS 010**



**5. SNAP HOOK
AZ 011**



**6. FULL BODY HARNESS
P-30**



RJ 500

Mobile anchor rail

EN 795:2012 CLASS D
CEN/TS 16415:2013

Ref.
no.: **RJ 500**

Mobile anchor rail RJ 500 is a complete fall protection system. An excellent structural stability is ensured by inertial mass comprising concrete blocks so it is not necessary to provide stable foundation or a support structure. RJ 500 is a modular device which can be interconnected to create any number of configurations and lengths as needed. Standard length of the rail is 6 running metres providing a track for horizontal travel of trolleys being anchor points for protected users. The rail is placed at 6.88 m. RJ 500 is a device that will suit perfectly i.e. when servicing tanks, on railway siding and repair stations and whenever it is necessary to move safely on horizontal surfaces at a height.

DANE TECHNICZNE

Material:	galvanized steel
Weight of concrete unit weights - 4 pcs.:	4100 kg
Weight of structure:	1420 kg
Length of rail of single segment:	6 m
Maximum number of users:	3

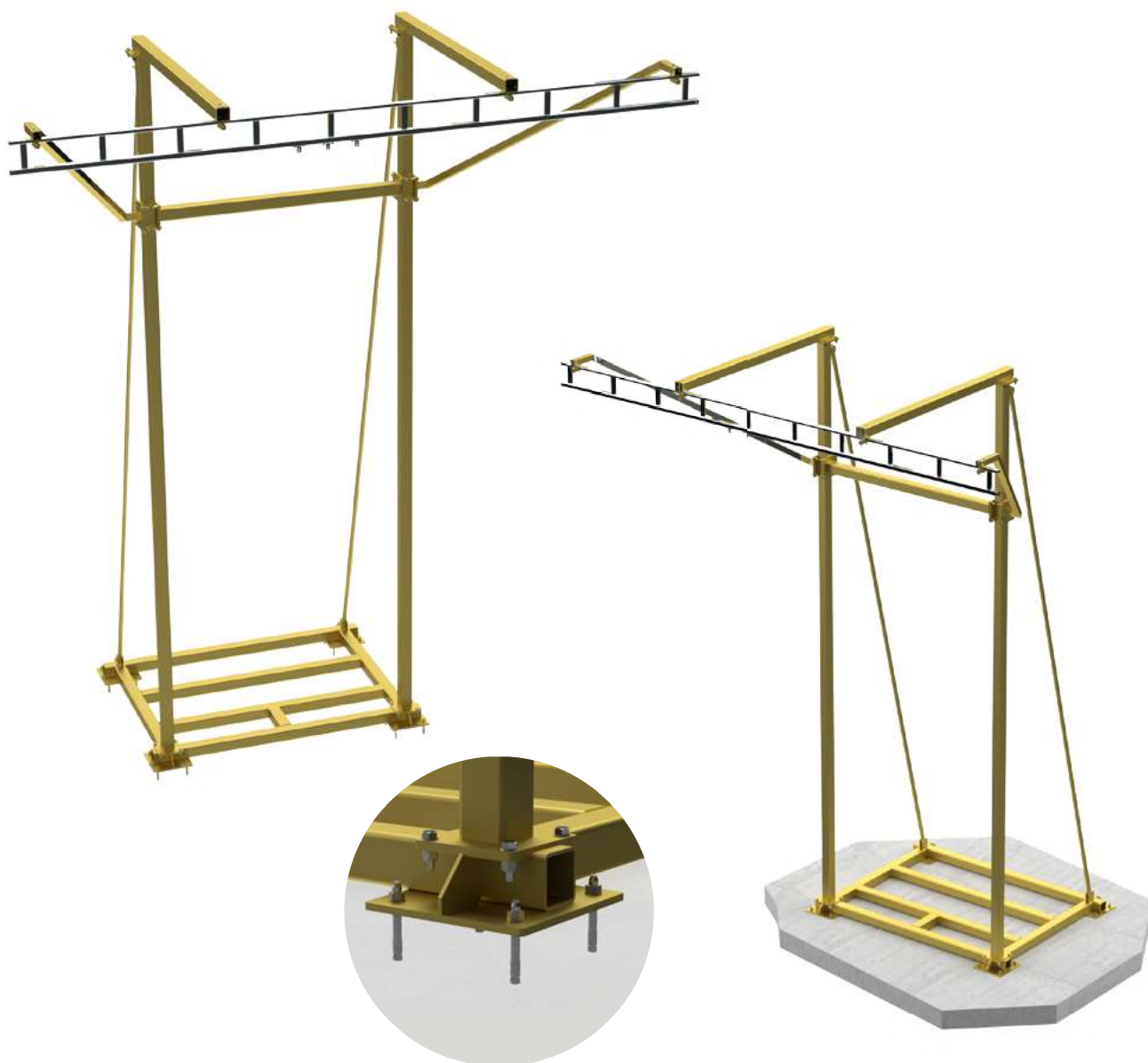

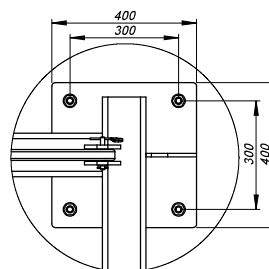
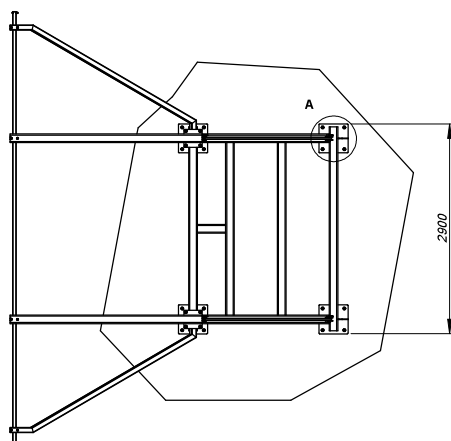
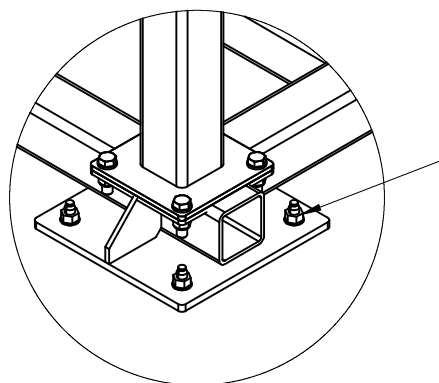
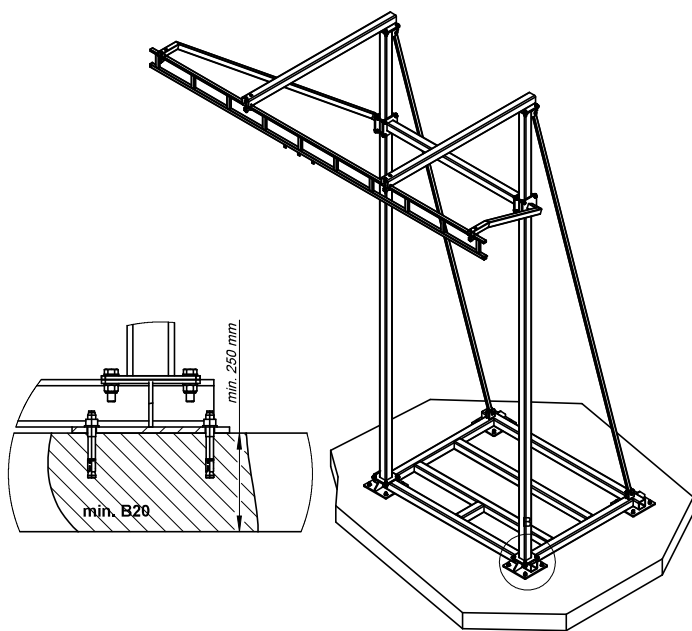
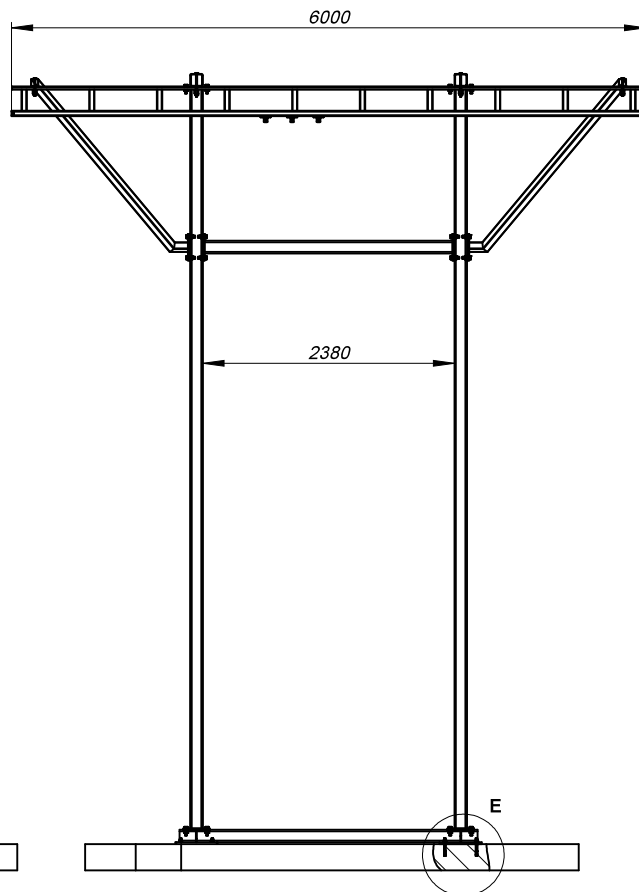
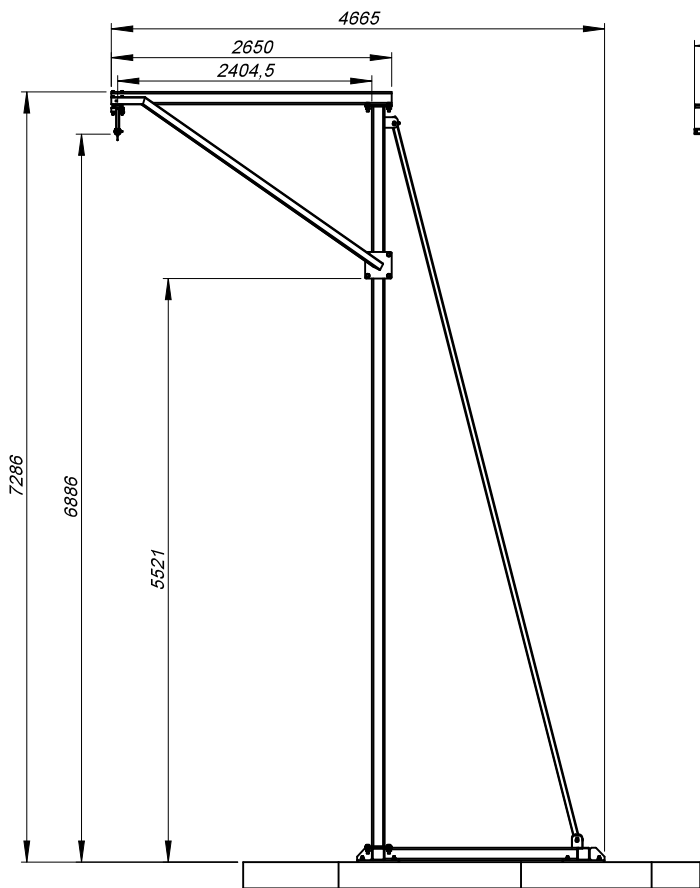

Elements of RJ500 kit

1. FRAME
RJ500 KIT



3. RETRACTABLE TYPEE FALL ARRESTER
CR 250V 10



**4. GUARD FOR RETRACTABLE
TYPEE FALL ARRESTER
OS 010**



**5. SNAP HOOK
AZ 011**



**6. FULL BODY HARNESS
P30**

